

## ORDER GUIDE

Type	Appearance (mm in)	Sensing range (Note)	Model No.	Output	Output operation
Standard		Maximum operation distance 5 mm 0.197 in	<b>GL-18H</b>	NPN open-collector transistor	Normally open
		Stable sensing range (0 to 4 mm 0 to 0.157 in)	<b>GL-18HI</b>		
			<b>GL-18HB</b>		Normally closed
Long sensing range		12 mm 0.472 in (0 to 10 mm 0 to 0.394 in)	<b>GL-18HL</b>		Normally open
			<b>GL-18HLI</b>		Normally closed
			<b>GL-18HLB</b>		Normally closed

### Accessory

- **MS-GL18HL** (Sensor mounting bracket)

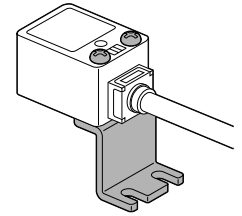

Two M3 (length 25 mm 0.984 in) pan head screws are attached.

Note: The maximum operation distance stands for the maximum distance for which the sensor can detect the standard sensing object.  
 The stable sensing range stands for the sensing range for which the sensor can stably detect the standard sensing object even if there is an ambient temperature drift and/or supply voltage fluctuation.

## SPECIFICATIONS

Item	Type Model No.	Standard			Long sensing range		
		GL-18H	GL-18HI	GL-18HB	GL-18HL	GL-18HLI	GL-18HLB
Max. operation distance (Note)		5 mm 0.197 in ± 10 %			12 mm 0.472 in ± 10 %		
Stable sensing range (Note)		0 to 4 mm 0 to 0.157 in			0 to 10 mm 0 to 0.394 in		
Standard sensing object		Iron sheet 25 × 25 × t 1 mm 0.984 × 0.984 × t 0.039 in			Iron sheet 40 × 40 × t 1 mm 1.575 × 1.575 × t 0.039 in		
Hysteresis		15 % or less of operation distance					
Supply voltage		10 to 30 V DC Ripple P-P 10 % or less					
Current consumption		10 mA or less					
Output		NPN open-collector transistor					
		<ul style="list-style-type: none"> <li>• Maximum sink current: 100 mA</li> <li>• Applied voltage: 30 V DC or less (between output and 0 V)</li> <li>• Residual voltage: 1.5 V or less (at 100 mA sink current)</li> <li>0.4 V or less (at 16 mA sink current)</li> </ul>					
Utilization category		DC-12 or DC-13					
Output operation		Normally open	Normally closed	Normally open	Normally open	Normally closed	
Max. response frequency		1 kHz			500 Hz		
Operation indicator		Red LED (lights up when the output is ON)					
Environmental resistance	Pollution degree	3 (Industrial environment)					
	Protection	IP67 (IEC), IP67g (JEM)					
	Ambient temperature	− 25 to + 70 °C − 13 to + 158 °F, Storage: − 25 to + 70 °C − 13 to + 158 °F					
	Ambient humidity	45 to 85 % RH, Storage: 45 to 85 % RH					
	EMC	EN 50081-2, EN 50082-2, EN 60947-5-2					
	Voltage withstandability	1,000 V AC for one min. between all supply terminals connected together and enclosure					
	Insulation resistance	50 MΩ, or more, with 250 V DC megger between all supply terminals connected together and enclosure					
	Vibration resistance	10 to 55 Hz frequency, 1.5 mm 0.059 in amplitude in X, Y and Z directions for two hours each					
Shock resistance	1,000 m/s <sup>2</sup> acceleration (100 G approx.) in X, Y and Z directions for three times each						
Sensing range variation	Temperature characteristics	Over ambient temperature range − 25 to + 70 °C − 13 to + 158 °F: within ± 10 % of sensing range at 20 °C + 68 °F					
	Voltage characteristics	Within ± 2 % for ± 10 % fluctuation of the supply voltage					
Material		Enclosure: Polyarylate					
Cable		0.3 mm <sup>2</sup> 3-core oil resistant cabtyre cable, 1 m 3.281 ft long					
Cable extension		Extension up to total 100 m 328.084 ft is possible with 0.3 mm <sup>2</sup> , or more, cable.					
Weight		45 g approx.					
Accessory						<b>MS-GL18HL</b> (Sensor mounting bracket): 1 set	

Note: The maximum operation distance stands for the maximum distance for which the sensor can detect the standard sensing object.  
 The stable sensing range stands for the sensing range for which the sensor can stably detect the standard sensing object even if there is an ambient temperature drift and/or supply voltage fluctuation.